

CSR Lamps

The GE CSR12000/DE is a double ended metal halide lamp that provides high efficiency, excellent color rendering, hot restrike capability, and a daylight color temperature. The CSR12000/DE is used in the film and event lighting field of entertainment lighting.

Product Description CSR12000/DE

•Order Description	CSR12000/DE
•Product Code	48457
•Pack Quantity	4
•Rated Wattage	12,000W
•Rated Voltage	160± V
•Lamp Current (ECG/MCG)*	75.0A
•Ignition Voltage (cold/hot)	8/75(MAX)
•Lumens	1,100,000 Lm
•Lumens per watt	92
•Ra	>90
•Chromaticity coordinates	x 0.323 y 0.325
•Color temperature	6,000K
•Arc Length	32(MAX)mm
•Lamp length	470
•Light center length	
•Lamp diameter	MAX78
•Average rated life	300hr
•Base	30x70 Cyl 165mm

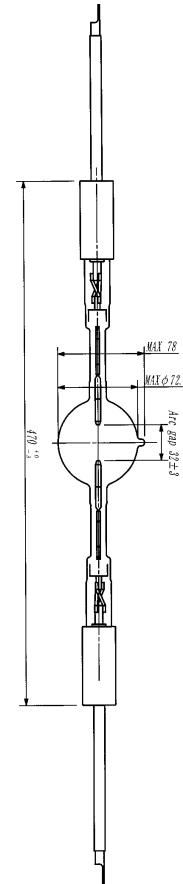

*ECG = electronic control gear/ MCG = Magnetic control gear

Lamp Operation

Burn Position	H15
Maximum Seal Temperature	350 ° C
Cooling	Forced Cooling/Fan
Lamp can be used	on electronic or AC magnetic
Ballast/igniters	

Application Information

- Do not exceed rated wattage or voltage
- Replace lamp at or before rated life
- Do not exceed rated seal temperature
- Use only with properly rated fixtures and ballasts



GE imagination at work

Distributor:



Phone: 407-857-8770
Fax: 407-857-8771
Email: sales@techni-lux.com